

The **SEDOR® function** analyses the images of a camera and creates a reference data set. All subsequent images are analysed as well and compared with the reference data by a **SEDOR® module**.

If certain comparison criteria differ, a detection event is assumed. Each detection event can trigger one or more actions.

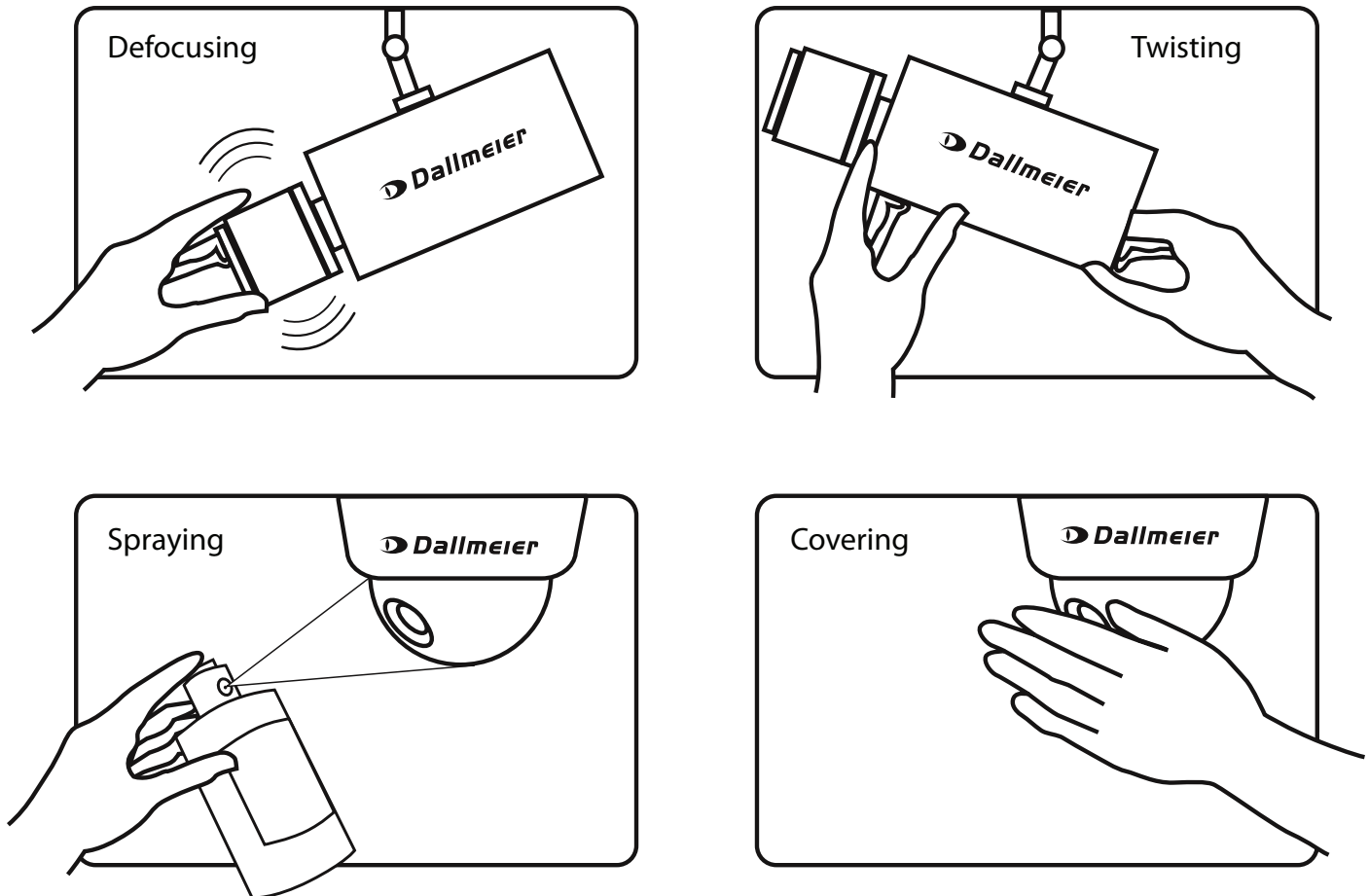

The **SEDOR® Camera Sabotage Protection module** detects the manipulation of a camera, such as, for example, by defocusing, twisting, spraying or covering. A detected sabotage event can trigger a system message, the sending of a message to an alarm host or the switching of a relay.

Note that

- *this function is not suitable for PTZ cameras.*
- *the camera must be mounted vibration-free.*
- *new reference data is created after each detected event.*
- *changing ambient conditions (brightness, rainfall) may cause false messages.*